



**130.8561 • 130.8562**  
**130.8563 • 130.8564**  
**130.8565**

**130.8571 • 130.8572**  
**130.8573 • 130.8574**  
**130.8575 • 130.8576**  
**130.8577 • 130.8578**  
**130.8579 • 130.8580**

- DE** Flach-Schwenktrog  
mit Edelstahlkonsolen  
Wasserdruck max. 5 bar
- EN** Flat Tip-Over Trough  
with stainless steel fixation  
water pressure max. 5 bar / 73 psi
- FR** Abreuvier Basculant Cuve Plate  
avec supports de fixation en Inox  
pression d'eau maxi 5 bar
- RU** Неглубокая переворачивающаяся поилка  
с креплениями для монтажа из нержавеющей стали  
Давление воды максимально 5 бар

**SUEVIA HAIGES GmbH**

Max-Eyth-Str. 1

D-74366 Kirchheim am Neckar · Germany

Tel. +49 7143 971-0 · Fax +49 7143 971-80

www.suevia.com · info@suevia.com



# Mounting + Electrical connection

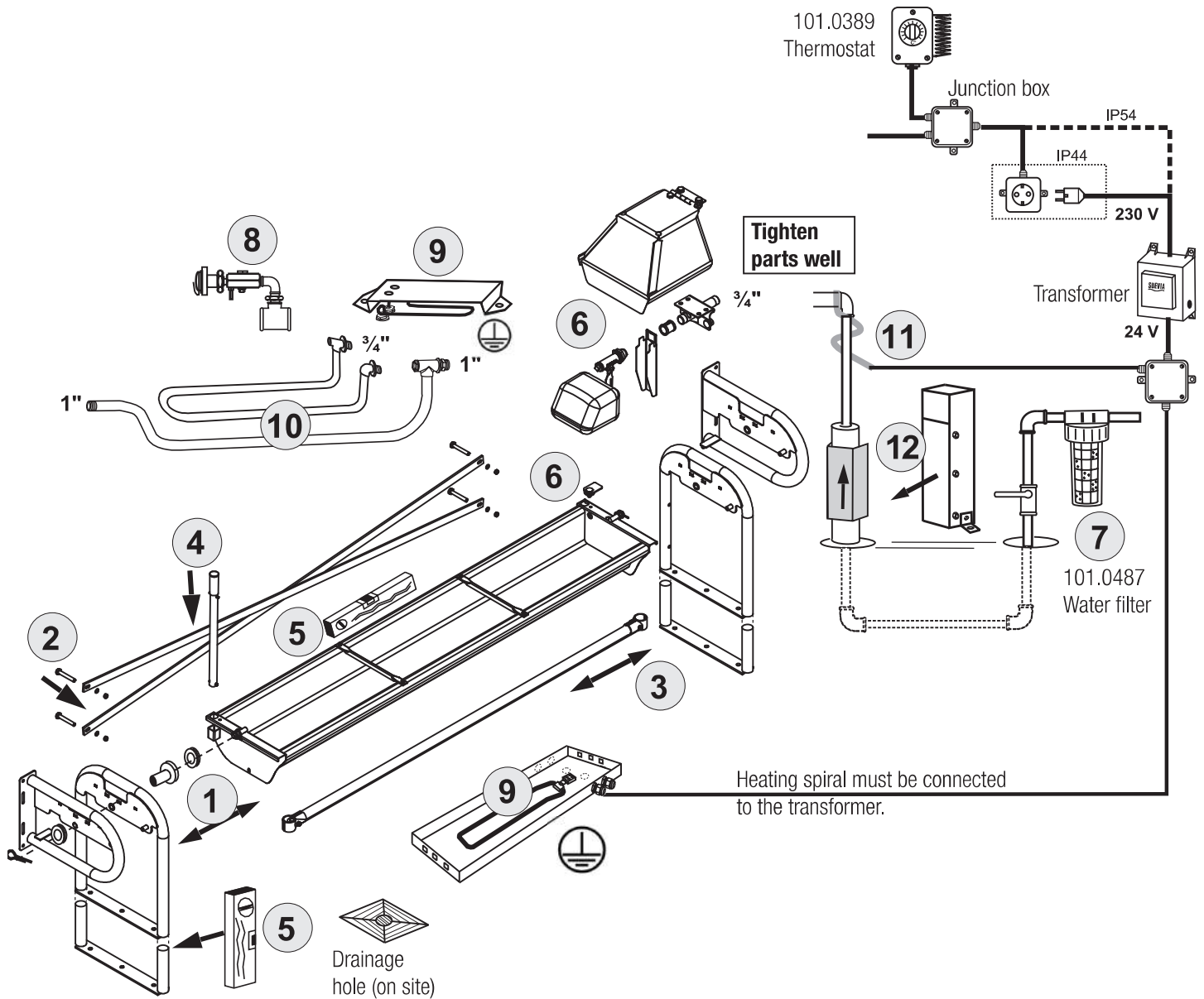

## Mounting

1. Mount the right and the left side parts of the trough
2. Install cross beams diagonally and screw them tightly (only for floor mounting).
3. Fix the protecting tube
4. Install the tip-over lever and secure it with the screw M6
5. Align the trough and the right and the left side parts, screw them to the wall or the ground
6. Fix the valve body, the lever with the floater, the cover and the angle bracket, mount the trough lock  
→ alternatively from the right or the left side of the trough (mount the lever always on the other side of valve position)
7. Connect the water supply line 3/4"  
→ water connection can be done alternatively from beneath or from the side. Observe DIN 1988 / DIN EN 1717!  
→ water pressure max. 5 bar (73 psi)

**Attention!** Flush water line well before you connect the trough! If dirty water (sand, suspended matters) is given, SUEVIA preliminary filter (101.0487) must be installed before the trough drinker.

## Optional

8. Fix the frost protection guard (131.0592, see an additional mounting instructions)
9. Fix the heating element. Connect it to the electricity means of a transformer (see an additional mounting instructions)
10. Fix the circuit pipe 3/4" (131.0591) or 1" (131.6122, 131.6123, 131.6124, 131.6125) to the water circuit (see the mounting instructions of the heating unit and of the circuit pipe)
11. To ensure a frost-free feed pipe, wrap a frost protection heating cable around the pipe. Connect it to the electricity means of a transformer.
12. The power supply cable, the heating cable and the insulation have to be protected against bites of animals or damages  
→ fix the biting protection shield for connections from beneath (131.0581)

# Dimensions (mm)

## Ground fixation

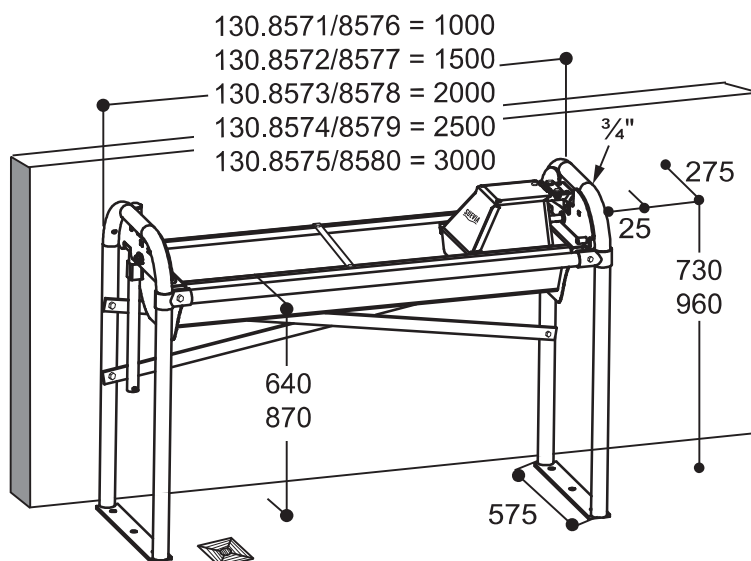

### Drilling pattern on the ground

For fixation of the trough 6 bolts are necessary.

- 130.8571/8576 = 930
- 130.8572/8577 = 1430
- 130.8573/8578 = 1930
- 130.8574/8579 = 2430
- 130.8575/8580 = 2930



## Wall fixation

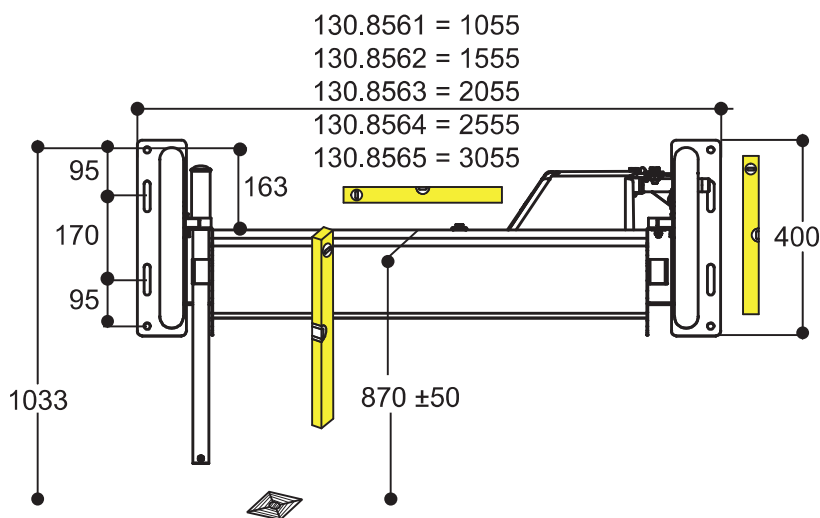

### Drilling pattern on the ground

For fixation of the trough 8 bolts are necessary.

- 130.8561 = 1015
- 130.8562 = 1515
- 130.8563 = 2015
- 130.8564 = 2515
- 130.8565 = 3015

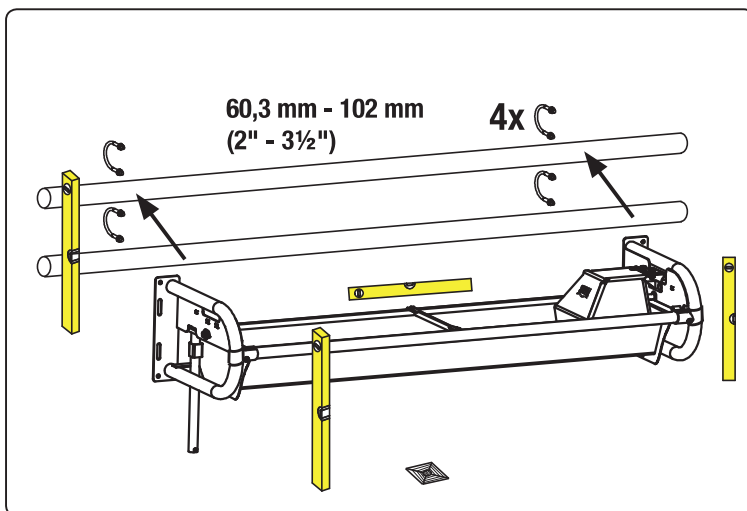
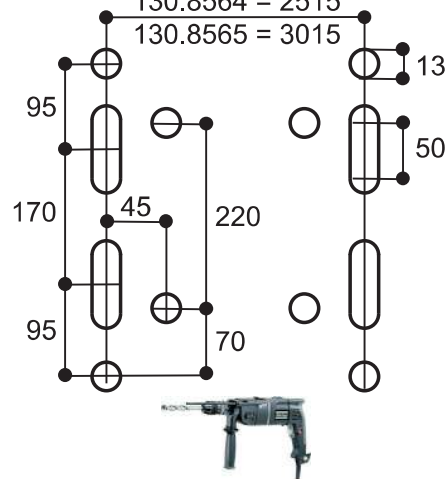

DE	FR
1/2"	15/21 mm
3/4"	20/27 mm
1"	26/34 mm
1 1/4"	33/42 mm
1 1/2"	40/49 mm
2"	50/60 mm
2 1/2"	66/76 mm
3"	80/90 mm
3 1/2"	90/102 mm
4"	102/114 mm
5"	125/139 mm

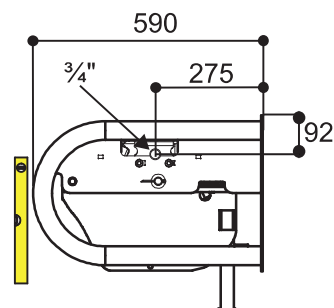

# Five options of frost protection

## 1. Heating element 24 V, for installation into the trough

(see separate mounting instructions)

Heating element 24 V, 180 W (131.6063) for installation into the trough.



## 2. Heating element 24 V, for installation under the trough

(see separate mounting instructions)

Heating element 24 V (131.6060, 131.6061, 131.6062, 131.6062 + 131.6088) for installation under the trough. For power supply a SUEVIA Transformer 230/24 V is necessary. For automatic switch on/off of transformer a thermostat (101.0389) can be additionally installed. To ensure a frost-free feed pipe, a frost protection heating cable 24 V, 20 W, 2 m (101.0861), or a 24 V, 30 W, 3 m (101.1863) has to be used. The heating cable should be wrapped around the pipe and connected to the heating element of the drinker in parallel to the power supply cable, coming from the transformer. If this heating cable is installed on plastic pipes, make sure that this water pipe is suited for warm and cold water. For better heat distribution the water pipe has to be wrapped first with an aluminium adhesive tape (101.1099). The frost protection heating cable and the supply line should be protected against animal bites or other damages.

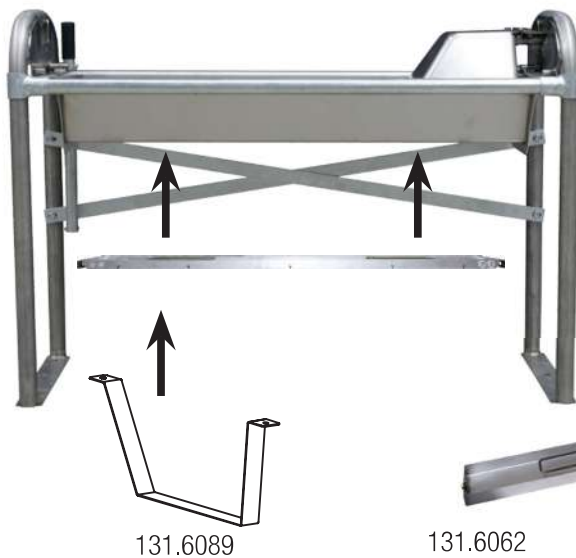

131.6062

131.6061

131.6060

## 3. Connection to a water circuit with a circuit pipe

3/4" circuit pipe (131.0591) or 1" circuit pipe (131.6122, 131.6123, 131.6124, 131.6125) suited for installation into all flat tip-over troughs. Frost protection is reached for the water line as well as for the water in the trough, if connected to a water circuit with a SUEVIA heating unit.

131.0591

131.6122 • 131.6123 • 131.6124 • 131.6125

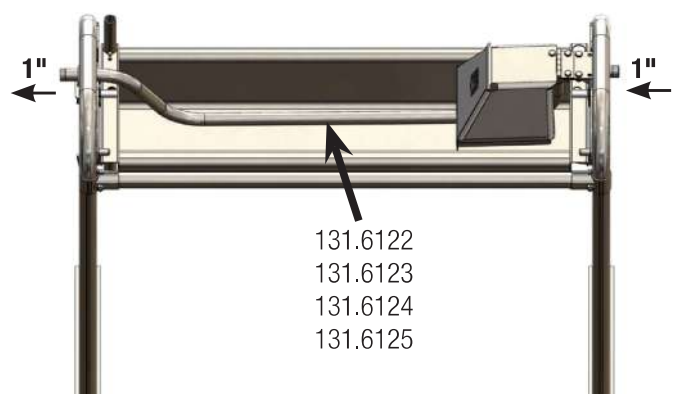
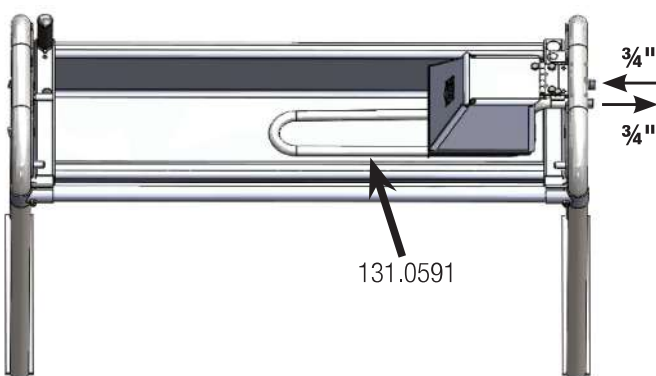

## Five options of frost protection

### 4. Increased frost protection of the valve

For extremely cold areas subsequent installation of a valve heating model 527 (131.0527, 24 V, 7 W) is recommended for increased frost protection.



### 5. Frost protection by running water

SUEVIA frost protection guard with connection parts (131.0592).

For subsequent installation into SUEVIA flat tip-over troughs. **Frost protection without electricity!** At risk of frost the installed and adjusted frost protection guard opens automatically, the adjusted water quantity flows into the trough over the float valve, situated under the frost protection guard: water in the trough remains in motion and is prevented from freezing! Surplus water produced by the frost protection guard is channeled well directed through the drainage kit (132.1254), which is mounted opposite to the float valve at the rear side of the trough.



### Optional

**Bite protection shield**, for SUEVIA frost protection heating cables when mounted on SUEVIA flat tip-over troughs:

- if water line comes **from beneath** (131.0581)
- if water line is connected **from the side** (131.0582)





# Water Level Adjustment

## Water Level Adjustment

Water level can be adjusted means of height adjustment of the floater.

For this purpose lift up the locking screw (1). → Open the cover (2). Loose the hexagon nut (102.0621) (3), adjust the floater at desired height (3) and tighten the nut on again. Close the cover. Click into place the locking screw.

Take care of the following:

Float valve has to be placed that way that it is situated in a 90° angle to the valve lever (102.0393).

Water pressure max. 5 bar (73 psi)



## Max. cable lengths

Section e.g.: Type NYY	till 100 Watt	till 200 Watt	till 300 Watt	till 400 Watt
2,5 mm <sup>2</sup>	83 m	42 m	28 m	21 m
4,0 mm <sup>2</sup>	132 m	66 m	44 m	33 m
6,0 mm <sup>2</sup>	200 m	100 m	66 m	50 m

### Attention!

The drinking bowl must **not be run without water** if the heating is activated!

Guidelines. Please note cable data sheets and local standards.

All installation, maintenance and inspection works must be carried out by an authorised and qualified specialist. Local norms must be respected. We recommend to ground the drinker due to electrostatic discharges. ⚡

**The clamps must be drilled and secured with additional fastening screws.**

